

Hi Power LEDs

RoHS Compliant This product is RoHS compliant.



LUMEX SUNBRITE GENERAL ILLUMINATION LED LIGHT BARS

* 6", 12", and 24" LED Lightbars available

For quantities greater than listed, call for quote.

MOUSER STOCK NO.	Lumex Part No.	Fig.	Emitting Color	# of LEDs	CCT(k)	Watts	Lumens	Length	Voltage	Viewing Angle	Price Each			
											1	10	25	100
696-SSP-LB06MW024K03	SSP-LB06MW024K03	A	Warm White	6	2600-3000	2.5	150	6"	24 VDC	120	23.00	21.28	20.37	17.83
696-SSPLBK12MW024K03	SSP-LBK12MW024K03	A	Warm White	6	2600-3000	2.5	150	6"	24 VDC	120	54.19	50.15	48.00	42.00
696-SSP-LB12MW024K03	SSP-LB12MW024K03	A	Warm White	12	2600-3000	3.3	190	12"	24 VDC	120	34.66	32.07	30.70	26.86
696-SSP-LB12MW024K05	SSP-LB12MW024K05	A	Warm White	12	2600-3000	5	300	12"	24 VDC	120	43.16	39.94	38.23	33.45
696-SSP-LB12NW024K03	SSP-LB12NW024K03	A	Neutral White	12	3700-4300	3.3	220	12"	24 VDC	120	34.66	32.07	30.70	26.86
696-SSP-LB12NW024K05	SSP-LB12NW024K05	A	Neutral White	12	3700-4300	5	300	12"	24 VDC	120	43.16	39.94	38.23	33.45
696-SSP-LB12UW024K03	SSP-LB12UW024K03	A	Cool White	12	5000-6300	3.3	220	12"	24 VDC	120	34.66	32.07	30.70	26.86
696-SSP-LB12UW024K05	SSP-LB12UW024K05	A	Cool White	12	5000-6300	5	360	12"	24 VDC	120	43.16	39.94	38.23	33.45
696-SSP-LB24MW024K10	SSP-LB24MW024K10	A	Warm White	24	2600-3000	10	600	24"	24 VDC	120	80.30	74.94	72.69	66.91
696-SSP-LB24UW024K07	SSP-LB24UW024K07	A	Cool White	24	5000-6300	6.6	440	24"	24 VDC	120	69.32	64.15	61.40	53.73

A

B

C

D

E

F

G

H

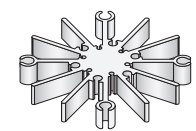
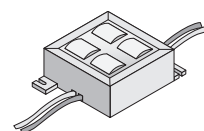
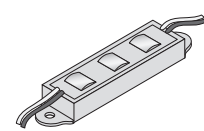
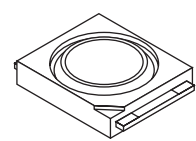

LUMEX LIGHT BAR ACCESSORIES



For quantities greater than listed, call for quote.

MOUSER STOCK NO.	Lumex Part No.	Description	Price Each
696-SSP-PW024	SSP-PW024	LED Power Supplies 24W Adapter 100-240VAC Output 24VDC / 1A	16.39
696-SSP-CA12	SSP-CA12	12" Power Line Connection Cable	2.52
696-SSP-CN10	SSP-CN10	10" Connection Cable between Light Bars	2.52
696-SSP-DM0	SSP-DM0	LED Power Supplies Dimmer Switch	18.60
696-SSP-MTCF1	SSP-MTCF1	LED Mounting Clip for Light Bars	.56

LUMEX TitanBrite™ LEDs

For quantities greater than listed, call for quote.

MOUSER STOCK NO.	Lumex Part No.	Fig.	Color	Color Temp/ Wavelength	Luminous Flux (lm)	Power (W)	Voltage (VDC)	Current (mA)	Price Each			
									1	10	50	100
696-LXL8047SICTR2	SML-LXL8047SICTR/2	B	Red	635nm	50	2	2.7	700	9.37	8.85	8.12	7.49
696-LXL8047SYCTR2	SML-LXL8047SYCTR/2	B	Yellow	598nm	55	2	2.5	700	9.37	8.85	8.12	7.49
696-LXL8047USBCTR3	SML-LXL8047USBCTR/3	B	Blue	454nm	20	3	4.6	1500	8.65	8.18	7.50	6.92
696-LXL8047MWCTR3	SML-LXL8047MWCTR/3	B	Warm White	3000K	140	3	4.6	1000	9.58	8.83	8.50	7.98
696-LXL8047UWCTR3	SML-LXL8047UWCTR/3	B	Cool White	6000K	160	3	4.6	1000	10.23	9.67	8.87	8.18
696-LXL99SIC-TR2	SML-LXL99SIC-TR/2	C	Red	635nm	42	2	2.7	700	8.21	7.76	7.12	6.57
696-LXL99SYC-TR2	SML-LXL99SYC-TR/2	C	Yellow	598nm	58	2	2.5	700	8.21	7.76	7.12	6.57
696-LXL99USBC-TR5	SML-LXL99USBC-TR/5	C	Blue	465nm	55	5	4.5	1500	19.96	18.97	17.51	16.26
696-LXL99MWC-TR5	SML-LXL99MWC-TR/5	C	Warm White	2700K	220	5	4.5	1500	20.93	19.88	18.35	17.04
696-LXL99UWC-TR5	SML-LXL99UWC-TR/5	C	Cool White	6000K	180	5	4.5	1500	20.93	19.88	18.35	17.04

OPTeK Technology OVSP SMD SERIES

For quantities greater than listed, call for quote.

MOUSER STOCK NO.	Lumex Part No.	Fig.	Color	Color Temp/ Wavelength	Luminous Flux (lm)	Power (W)	Voltage (VDC)	Current (mA)	Price Each			
									1	10	50	100
828-OVSPRBCR4	OVSPRBCR4	D	Red	625	26	1.2	2.5	0.4	2.10	1.62	1.46	1.32
828-OVSPW1BCR4	OVSPW1BCR4	D	White	---	90	1.2	3.5	0.35	3.27	2.64	2.40	1.82
828-OVSPW1BCR44	OVSPW1BCR44	--	White	---	90	1	3.5	0.35	2.20	2.12	2.04	1.96

OPTeK Technology LED LINKS

For quantities greater than listed, call for quote.

MOUSER STOCK NO.	Optek Part No.	Fig.	Color	Color Temp/ Wavelength	llumination (lux@0.5m)	Voltage (VDC)	Safety Grade	Price Each			
								1	10	50	100
828-OVQ12S30R7	OVQ12S30R7	E	Red	625nm	32	12	-	11.15	9.58	9.06	8.53
828-OVQ12S30Y7	OVQ12S30Y7	E	Yellow	590nm	32	12	-	11.15	9.58	9.06	8.53
828-OVQ12S30G7	OVQ12S30G7	E	Green	525nm	50	12	-	12.78	10.98	10.38	9.78
828-OVQ12S30B7	OVQ12S30B7	E	Blue	470nm	20	12	-	12.09	10.39	9.82	9.25
828-OVQ12S30WW7	OVQ12S30WW7	E	Warm White	3300K	60	12	-	13.49	11.60	10.97	10.33
828-OVQ12S30W7	OVQ12S30W7	E	White	5500K	68	12	-	12.94	11.12	10.52	9.91
828-OVM12F3R7	OVM12F3R7	F	Red	623nm	20	12	IP67	2.35	2.02	1.91	1.80
828-OVM12F3Y7	OVM12F3Y7	F	Yellow	590nm	18	12	IP67	2.35	2.02	1.91	1.80
828-OVM12F3G7	OVM12F3G7	F	Green	525nm	14	12	IP67	2.43	2.09	1.98	1.86
828-OVM12F3B7	OVM12F3B7	F	Blue	470nm	6	12	IP67	2.39	2.06	1.95	1.83
828-OVM12F3W7	OVM12F3W7	F	White	5000-7000K	16	12	IP67	2.90	2.49	2.36	2.22
828-OVM18F4R7	OVM18F4R7	G	Red	623nm	24	18	IP67	3.00	2.58	2.44	2.30
828-OVM18F4Y7	OVM18F4Y7	G	Yellow	590nm	22	18	IP67	3.00	2.58	2.44	2.30
828-OVM18F4G7	OVM18F4G7	G	Green	525nm	16	18	IP67	3.08	2.65	2.51	2.36
828-OVM18F4B7	OVM18F4B7	G	Blue	470nm	8	18	IP67	3.02	2.60	2.46	2.32
828-OVM18F4W7	OVM18F4W7	G	White	5000-7000K	20	18	IP67	4.33	3.72	3.52	3.31

OPTeK Technology LED LIGHT BARS



For quantities greater than listed, call for quote.

MOUSER STOCK NO.	Optek Part No.	Color	Color Temp.	Luminous (lm)	Length (in.)	Width (mm)	Current (mA)	Voltage (VDC)	Price Each			
									1	10	50	100
828-OPA779D610	OPA779D-610	Cool White	7000K	90	24	15.4	85	12	13.70	13.31	12.92	12.53
828-OPA779D1169	OPA779D-1169	Cool White	7000K	180	45	15.4	175	12	23.33	22.66	21.99	21.33

OHMITE S SERIES LED HEATSINKS

For quantities greater than listed, call for quote.

MOUSER STOCK NO.	Ohmite Part No.	Fig.	Surface Area (in ² /mm ²)	Thermal Resistance (°C/W)		Height (in/mm)	Price Each		
				Free Conv.	Forced Conv.		1	10	100
588-SV-LED-113E	SV-LED-113E	H	18 / 11,739	6.67	4.33	.50 / 12.7	3.05	2.50	2.22
588-SA-LED-113E	SA-LED-113E	H	18 / 11,739	5.33	4.33	.50 / 12.7	3.30	2.70	2.40
588-SV-LED-125E	SV-LED-125E	H	36 / 23,478	5.33	2.88	1.0 / 12.7	4.07	3.33	2.96
588-SA-LED-125E	SA-LED-125E	H	36 / 23,478	4.27	2.88	1.0 / 12.7	4.65	3.80	3.38
588-SV-LED-151E	SV-LED-151E	H	72 / 46,956	4.00	1.89	2.0 / 50.8	6.08	4.97	4.42
588-SA-LED-151E	SA-LED-151E	H	72 / 46,956	3.20	1.89	2.0 / 50.8	7.23	5.92	5.26
588-SV-LED-176E	SV-LED-176E	H	108 / 70,434	3.11	1.55	3.0 / 76.2	8.28	6.77	6.02
588-SA-LED-176E	SA-LED-176E	H	108 / 70,434	2.49	1.55	3.0 / 76.2	9.93	8.12	7.22