

SEOUL SEMICONDUCTOR LEDs

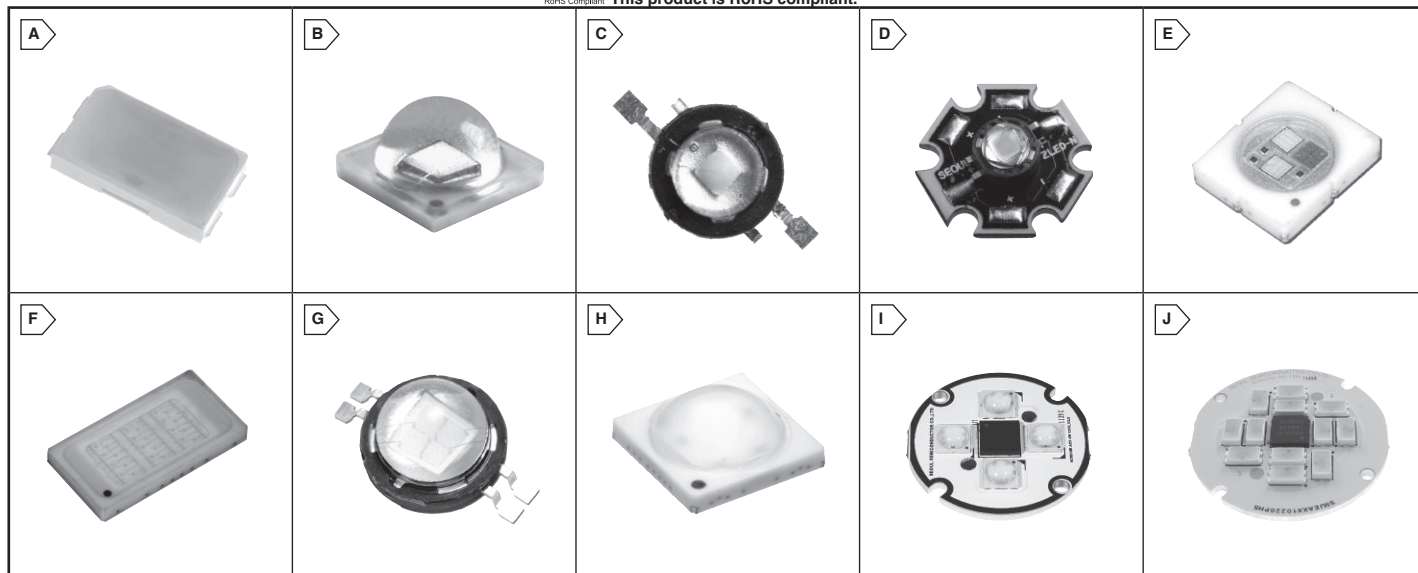

RoHS Compliant This product is RoHS compliant.



LED Lighting

Seoul Semiconductor

Z-POWER LEDs

Z-Power LEDs from Seoul Semiconductor have a low thermal resistance. They are environmentally friendly, and have a low energy consumption with a high output. Compatible Heat Sinks can be found in our Thermal Management Section of this Catalog.

For quantities greater than listed, call for quote.

MOUSER STOCK NO.	Seoul Part No.	Fig.	Color	Wavelength/ Color Temp.	Luminous Flux (lm)	Voltage (VDC)	Current	Price Each			
								1	10	50	100
0.4 Watt LEDs											
889-STW8Q2PAS0FA	STW8Q2PA-S0-FA	A	White	3700K	28.9	3.2	100	1.15	.88	.75	.63
889-STW8Q2PAS5CA	STW8Q2PA-S5-CA	A	White	5300K	30	3.2	100	1.15	.88	.75	.63
889-STW8Q2PAS5DA	STW8Q2PA-S5-DA	A	White	4700K	30	3.2	100	1.15	.88	.75	.63
889-STW8Q2PAS5EA	STW8Q2PA-S5-EA	A	White	4200K	30	3.2	100	1.15	.88	.75	.63
889-STW8Q2PASOGA	STW8Q2PA-SO-GA	A	White	3200K	28.9	3.2	100	1.15	.88	.75	.63
889-STW8Q2PASOHA	STW8Q2PA-SO-HA	A	White	2800K	28.9	3.2	100	1.15	.88	.75	.63
889-STW8Q2PAT0AA	STW8Q2PA-T0-AA	A	White	7000K	31	3.2	100	1.15	.88	.75	.63
889-STW8Q2PAT0BA	STW8Q2PA-T0-BA	A	White	6000K	31	3.2	100	1.15	.88	.75	.63
2.8 Watt LEDs											
889-SZR05A0A	SZR05A0A	B	Red	625nm	55	2.4	350mA	1.74	1.63	1.53	1.48
889-SZA05A0A	SZA05A0A	B	Amber	592nm	42	2.5	350mA	1.74	1.63	1.53	1.48
889-SZG05A0A	SZG05A0A	B	Green	525nm	100	3.3	350mA	2.72	2.56	2.40	2.32
889-SZB05A0A	SZB05A0A	B	Blue	465nm	28	3.3	350mA	2.19	2.06	1.94	1.87
889-SZW05A0A0U2	SZW05A0A-U2	B	Pure White	6300K	105	3.3	0.7	4.17	3.92	3.68	3.55
3.8 Watt LEDs											
889-R42180	R42180	C	Red	625nm	48	2.3	0.8A	5.91	4.92	4.59	3.58
889-G42180	G42180	C	Green	525nm	70	3.25	1.0A	9.00	7.80	7.70	5.25
889-B42180	B42180	C	Blue	465nm	22	3.25	1.0A	7.49	6.24	5.84	4.54
889-W4218006U3AR	W42180-06-U3-AR	C	Pure White	6300K	118	3.3	800mA	6.50	5.41	4.58	3.94
889-W4218006U3BR	W42180-06-U3-BR	C	Pure White	6300K	118	3.3	800mA	6.50	5.41	4.58	3.94
889-W4218006U3CR	W42180-06-U3-CR	C	Pure White	6300K	118	3.3	800mA	6.50	5.41	4.58	3.94
889-S4218006T2EL	S42180-06-T2-EL	C	Natural White	4000K	76	3.3	800mA	6.90	5.74	4.86	4.18
889-N4218006T2GL	N42180-06-T2-GL	C	Warm White	3000K	72	3.3	800mA	6.90	5.74	4.86	4.18
889-N4218006T1HL	N42180-06-T1-HL	C	Warm White	3000K	72	3.3	800mA	6.90	5.74	4.86	4.18
889-R42182	R42182	D	Red	625	48	2.3	0.8A	6.80	5.66	5.28	4.12
889-G42182	G42182	D	Green	527	70	3.25	1.0A	9.78	8.41	8.22	5.74
889-B42182	B42182	D	Blue	465	22	3.25	1.0A	8.29	7.05	6.55	5.03
889-N42182H-T2	N42182H-T2	D	Warm White	3000K	66	3.25	0.8A	9.17	7.63	6.46	5.56
889-W42182U	W42182-U	D	Pure White	6300K	100	3.25	1.0A	8.05	6.71	6.53	5.31
889-F50360	F50360	E	RGB	625/525/460	35/57/13	2.5/3.8/3.6	0.35A	14.30	13.75	11.41	9.07
4.5 Watt LEDs											
889-NZ20360-X1	NZ20360-X1	F	Warm White	3000K	200	11.0	0.4	10.96	9.11	7.72	6.64
889-SZ20360-X1	SZ20360-X1	F	Natural White	4000K	210	11.0	0.4	5.64	5.31	4.98	4.81
889-SZ20360-X2	SZ20360-X2	F	Natural White	4000K	210	11.0	0.4	5.64	5.31	4.98	4.81
10 Watt LED											
889-W724C0	W724C0	G	Pure White	6300K	700	3.6	2.8A	17.00	16.00	15.00	14.50

ACRICH SERIES AC LEDs

Designed for AC source operations and high flux output applications, Acrich is semi-permanent and environmental friendly semiconductor lighting that can be used in AC without additional devices. Acrich's thermal management performance exceeds other power LED solutions. This series incorporates state of the art SMD design and thermal emission material. These LED's are ideal light sources for general illumination applications.

For quantities greater than listed, call for quote.

MOUSER STOCK NO.	Seoul Part No.	Fig.	Color	Wavelength/ Color Temp.	Luminous Flux (lm)	Voltage (Max.)	Current	Price Each			
								1	10	50	100
889-AW320001X2AA	AW3200-01-X2-AA	G	Pure White	6300K	260	110VAC	40mA	7.50	6.50	5.45	4.37
889-AW320001X2BA	AW3200-01-X2-BA	G	Pure White	6300K	260	110VAC	40mA	7.50	6.50	5.45	4.37
889-AW320001X2CA	AW3200-01-X2-CA	G	Pure White	6300K	260	110VAC	40mA	7.50	6.50	5.45	4.37
889-AN320003W1GA	AN3200-03-W1-GA	G	Warm White	6300K	260	100VAC	40mA	7.50	6.50	5.45	4.37
889-AN320003W1HA	AN3200-03-W1-HA	G	Warm White	6300K	260	100VAC	40mA	7.50	6.50	5.45	4.37
889-AN424003SFA	AN4240-03-S-FA	H	Warm White	3000K	50	50VAC	20mA	4.13	3.44	2.98	2.50
889-AN424003SGA	AN4240-03-S-GA	H	Warm White	3000K	50	50VAC	20mA	4.13	3.44	2.98	2.50
889-AN424003SHA	AN4240-03-S-HA	H	Warm White	3000K	50	50VAC	20mA	4.13	3.44	2.98	2.50

ACRICH 2 SERIES AC LED MODULES

For quantities greater than listed, call for quote.

MOUSER STOCK NO.	Seoul Part No.	Fig.	No. of LEDs	Color	Wavelength/ Color Temp.	Luminous Flux (lm)	Voltage (Max.)	Power Rating (W)	Price Each			
									1	10	50	100
889-SMJPA3010120	SMJPA3010120	I	4	Warm White	3000K	290	120VAC	4	10.40	9.10	8.58	8.06
889-SMJEA3010220	SMJEA3010220	J	12	Warm White	3000K	290	120VAC	4	7.98	6.96	6.59	6.19