

MOLEX MX150L™ Sealed Connector System

molex
one company > a world of innovation

The MX150™ system from Molex is a rugged, environmentally-sealed connector system that supports both low-level signal applications as well as power applications up to 18.0A

*All discrete components shown to the right for both the receptacle and plug housings are pre-assembled. Terminals are simply crimped and poked into the housings. No additional wire seals, wedge locks or CPA locks are required.

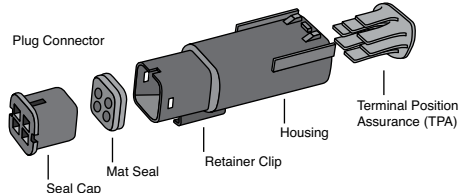
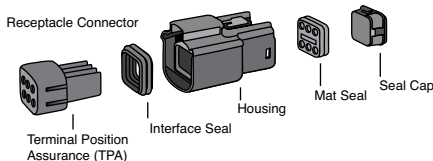

5.84MM (.230") PITCH MX150L™ - SINGLE ROW CONNECTORS

Features:

- Environmentally sealed to IP67
- Integrated mat wire seal
- Integrated interface seal (receptacles only)
- Integrated terminal position assurance (TPA)
- Simple crimp and poke application
- Field serviceable contact removal system
- Tactile and audible mating feedback

Specifications:

- 5.84mm (.230") Pitch
- Housing: SPS Glass-filled Crystalline Polymer
- Operating Temperature: -55 to +125°C
- Dielectric Withstanding Voltage: 1500V AC min.
- Insulation Resistance: 1000MΩ



RoHS Compliant

For quantities of 500 and up, call for quote.

MOUSER STOCK NO.	Molex Part No.	Fig.	No. of Circuits	Type	Wire Size AWG	Dimensions: mm (in.)		Price Each			
						A	1	10	50	100	
538-19418-0016	19418-0016	A	2	Receptacle	22-18	22.15 (.872)					
538-19418-0017	19418-0017	A	2	Receptacle	16-14	22.15 (.872)					
538-19419-0008	19419-0008	B	2	Plug	22-18	18.95 (.746)					
538-19419-0007	19419-0007	B	2	Plug	16-14	18.95 (.746)					

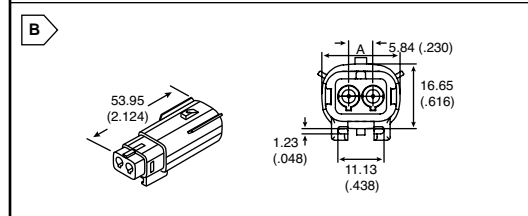
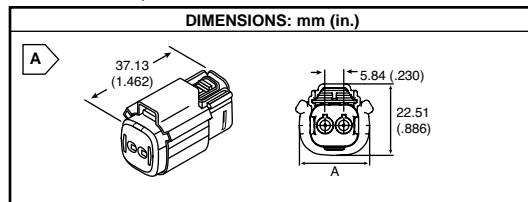

5.84MM (.230") PITCH MX150L™ - DUAL ROW CONNECTORS

Receptacles

For quantities of 500 and up, call for quote.

MOUSER STOCK NO.	Molex Part No.	Fig.	No. of Circuits	Wire Size AWG	Dimensions: mm (in.)		Price Each			
					A	1	10	50	100	
538-19418-0018	19418-0018	C	4	22-18	22.15 (.872)					
538-19418-0019	19418-0019	C	4	16-14	22.15 (.872)					
538-19418-0020	19418-0020	C	6	22-18	27.99 (1.102)					
538-19418-0021	19418-0021	C	6	16-14	27.99 (1.102)					
538-19418-0022	19418-0022	C	8	22-18	33.83 (1.332)					
538-19418-0023	19418-0023	C	8	16-14	33.83 (1.332)					
538-19418-0024	19418-0024	C	10	22-18	39.67 (1.562)					
538-19418-0025	19418-0025	C	10	16-14	39.67 (1.562)					
538-19418-0038	19418-0038	C	12	22-18	45.51 (1.792)					
538-19418-0040	19418-0040	C	16	22-18	57.19 (2.252)					
538-19418-0039	19418-0039	C	16	16-14	57.19 (2.252)					

Plugs

For quantities of 500 and up, call for quote.

MOUSER STOCK NO.	Molex Part No.	Fig.	No. of Circuits	Wire Size AWG	Dimensions: mm (in.)		Price Each			
					A	1	10	50	100	
538-19419-0005	19419-0005	D	4	22-18	18.94 (.746)					
538-19419-0004	19419-0004	D	4	16-14	18.94 (.746)					
538-19419-0012	19419-0012	D	6	22-18	24.78 (.976)					
538-19419-0011	19419-0011	D	6	16-14	24.78 (.976)					
538-19419-0001	19419-0001	D	8	22-18	30.62 (1.206)					
538-19419-0002	19419-0002	D	8	16-14	30.62 (1.206)					
538-19419-0015	19419-0015	D	10	22-18	36.47 (1.436)					
538-19419-0014	19419-0014	D	10	16-14	36.47 (1.436)					
538-19419-0020	19419-0020	D	16	22-18	53.99 (2.126)					

Contacts

Features:

- Mat seal friendly design features center seam and coined edges
- Anti-over stress beam geometry feature
- Low insertion force

Specifications:

- Contact: C19025 Copper Alloy
- Plating: Tin
- Operating Temperature: -55 to +125°C
- Voltage: 600V
- Current: 18.0A
- Durability: 25 cycles for Tin plating



RoHS Compliant

For quantities of 2000 and up, call for quote.

MOUSER STOCK NO.	Molex Part No.	Fig.	Type	Wire Size AWG	Price Each			
					1	100	500	1000
538-19420-0010	19420-0010	E	Female	22-18				
538-19420-0009	19420-0009	E	Female	16-14				
538-19417-0048	19417-0048	F	Male	22-18				
538-19417-0047	19417-0047	F	Male	16-14				

Tools

For quantities greater than listed, call for quote.

MOUSER STOCK NO.	Molex Part No.	Fig.	Description	Price Each	
				1	5
538-63813-1500	63813-1500	G	Extraction Tool		
538-63811-4400	63811-4400	H	Hand Crimp Tool		
538-64016-0035	64016-0035	---	Service Tool (only)		

MX150L™ CIRCUIT PLUG

With the application of optional circuit plugs, the MX150L™ system supports the ability to implement sealed blank cavities in both plug and receptacle housings. The circuit plugs occupy and fully seal the unused cavity and can be extracted and replaced with a standard male blade or female receptacle terminal. This feature provides the ability to plan for possible future circuit additions while maintaining the sealing integrity of the mated pair.



RoHS Compliant

Materials: • SPS Glass-filled Crystalline Polymer

For quantities of 2000 and up, call for quote.

MOUSER STOCK NO.	Molex Part No.	Fig.	Price Each			
			1	100	500	1000
538-19417-0119	19417-0119	I				

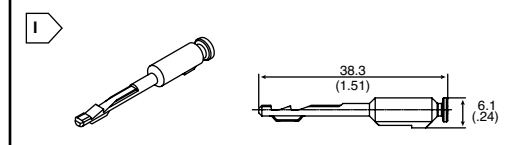
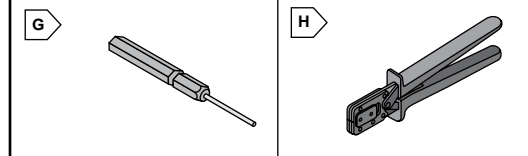
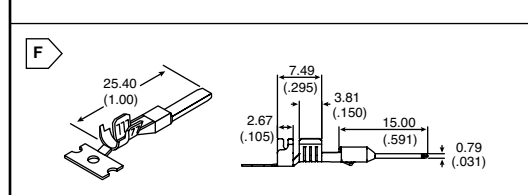
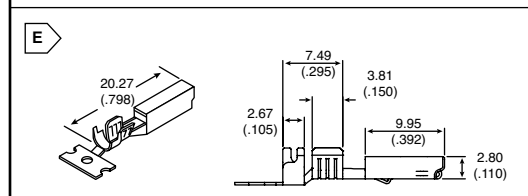
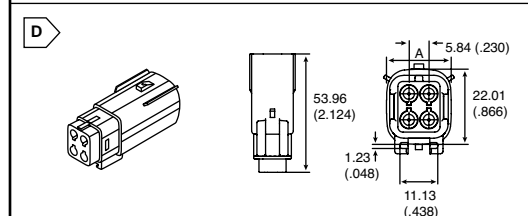
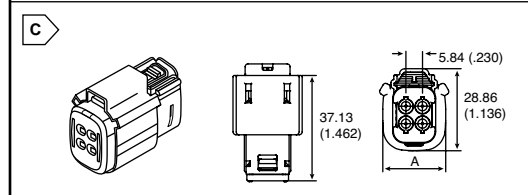
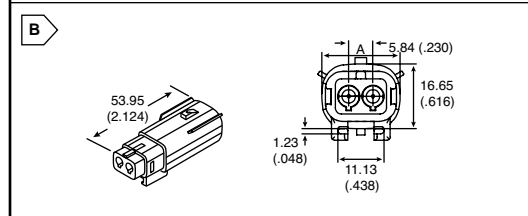

Rectangular Connectors Molex