

AMPHENOL Miniature Cylindrical Connectors



MS TYPE ENVIRONMENTAL MINIATURE BAYONET CONNECTORS (MIL-C-26482, SERIES 1)

Features:

- Bayonet couplings with 5 key/keyway polarization
- Visual confirmation of complete mating
- Durable, field-proven design
- Solder contacts
- All connectors shipped assembled and individually packaged

Specifications:

- Temperature Range: -40° F to + 185°F (IEC 60068-1)
- Shells: Fabricated from high grade aluminum alloy with an olive drab chromate finish
- Contacts: Machined copper alloy
- Inserts: Black resilient neoprene with white printing

Mating Information:

- Receptacles mate with plugs on the same line.

Box Mount Receptacle

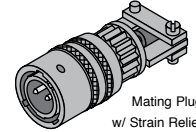
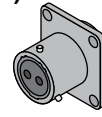

Mating Plug w/ Strain Relief

Insert Arrangements (Front View of Pin Insert)									
(Drawings Not to Scale)									
Insert Arrangement	8-2	8-3	12-3	8-4	14-5	10-6	12-8	16-8	12-10
Contacts	2 #20	3 #20	3 #16	4 #20	5 #16	6 #20	8 #20	8 #16	10 #20
Insert Arrangement	18-11	14-12	14-15	20-16	14-18	14-19			
Contacts	11 #16	8 #20 4 #16	14 #20 1 #16	16 #16	18 #20	19 #20			
Insert Arrangement	16-26	18-32	20-41	22-55	24-61				
Contacts	26 #20	32 #20	41 #20	55 #20	61 #20				

Amphenol Circular Connectors

Box Mount Receptacles

Straight Plugs

For quantities of 50 and up, call for quote.

# of Pos.	Insert Arrangement	Contact Size	Test Current	MOUSER STOCK NO.	Amphenol Part No.	Contact Type	Price Each			MOUSER STOCK NO.	Amphenol Part No.	Contact Type	Price Each		
							1	5	10				1	5	10
2	8-2	#20	7.5A	654-MS3112E8-2S	MS3112E8-2S	Socket				654-MS3116F8-2P	MS3116F8-2P	Pin			
	8-2	#20	7.5A	654-MS3112E8-2P	MS3112E8-2P	Pin				654-MS3116F8-2S	MS3116F8-2S	Socket			
3	8-3	#20	7.5A	654-MS3112E8-3S	MS3112E8-3S	Socket				654-MS3116F8-3P	MS3116F8-3P	Pin			
3	8-3	#20	7.5A	654-MS3112E8-3P	MS3112E8-3P	Pin				654-MS3116F8-3S	MS3116F8-3S	Socket			
3	12-3	#16	13.0A	654-MS3112E12-3S	MS3112E12-3S	Socket				654-MS3116F12-3P	MS3116F12-3P	Pin			
3	12-3	#16	13.0A	654-MS3112E12-3P	MS3112E12-3P	Pin				654-MS3116F12-3S	MS3116F12-3S	Socket			
4	8-4	#20	7.5A	654-MS3112E8-4S	MS3112E8-4S	Socket				654-MS3116F8-4P	MS3116F8-4P	Pin			
4	8-4	#20	7.5A	654-MS3112E8-4P	MS3112E8-4P	Pin				654-MS3116F8-4S	MS3116F8-4S	Socket			
5	14-5	#16	13.0A	654-MS3112E14-5S	MS3112E14-5S	Socket				654-MS3116F14-5P	MS3116F14-5P	Pin			
5	14-5	#16	13.0A	654-MS3112E14-5P	MS3112E14-5P	Pin				654-MS3116F14-5S	MS3116F14-5S	Socket			
6	10-6	#20	7.5A	654-MS3112E10-6S	MS3112E10-6S	Socket				654-MS3116F10-6P	MS3116F10-6P	Pin			
6	10-6	#20	7.5A	654-MS3112E10-6P	MS3112E10-6P	Pin				654-MS3116F10-6S	MS3116F10-6S	Socket			
8	12-8	#20	7.5A	654-MS3112E12-8S	MS3112E12-8S	Socket				654-MS3116F12-8P	MS3116F12-8P	Pin			
8	12-8	#20	7.5A	654-MS3112E12-8P	MS3112E12-8P	Pin				654-MS3116F12-8S	MS3116F12-8S	Socket			
8	16-8	#16	13.0A	654-MS3112E16-8S	MS3112E16-8S	Socket				654-MS3116F16-8P	MS3116F16-8P	Pin			
8	16-8	#16	13.0A	654-MS3112E16-8P	MS3112E16-8P	Pin				654-MS3116F16-8S	MS3116F16-8S	Socket			
10	12-10	#20	7.5A	654-MS3112E12-10S	MS3112E12-10S	Socket				654-MS3116F12-10P	MS3116F12-10P	Pin			
10	12-10	#20	7.5A	654-MS3112E12-10P	MS3112E12-10P	Pin				654-MS3116F12-10S	MS3116F12-10S	Socket			
11	18-11	#16	13.0A	654-MS3112E18-11S	MS3112E18-11S	Socket				654-MS3116F18-11P	MS3116F18-11P	Pin			
11	18-11	#16	13.0A	654-MS3112E18-11P	MS3112E18-11P	Pin				654-MS3116F18-11S	MS3116F18-11S	Socket			
8+4	14-12	#20/16	7.5/13.0A	654-MS3112E14-12S	MS3112E14-12S	Socket				654-MS3116F14-12P	MS3116F14-12P	Pin			
8+4	14-12	#20/16	7.5/13.0A	654-MS3112E14-12P	MS3112E14-12P	Pin				654-MS3116F14-12S	MS3116F14-12S	Socket			
14+1	14-15	#20/16	7.5/13.0A	654-MS3112E14-15S	MS3112E14-15S	Socket				654-MS3116F14-15P	MS3116F14-15P	Pin			
14+1	14-15	#20/16	7.5/13.0A	654-MS3112E14-15P	MS3112E14-15P	Pin				654-MS3116F14-15S	MS3116F14-15S	Socket			
16	20-16	#16	13.0A	654-MS3112E20-16S	MS3112E20-16S	Socket				654-MS3116F20-16P	MS3116F20-16P	Pin			
16	20-16	#16	13.0A	654-MS3112E20-16P	MS3112E20-16P	Pin				654-MS3116F20-16S	MS3116F20-16S	Socket			
18	14-18	#20	7.5A	654-MS3112E14-18S	MS3112E14-18S	Socket				654-MS3116F14-18P	MS3116F14-18P	Pin			
18	14-18	#20	7.5A	654-MS3112E14-18P	MS3112E14-18P	Pin				654-MS3116F14-18S	MS3116F14-18S	Socket			
19	14-19	#20	7.5A	654-MS3112E14-19S	MS3112E14-19S	Socket				654-MS3116F14-19P	MS3116F14-19P	Pin			
19	14-19	#20	7.5A	654-MS3112E14-19P	MS3112E14-19P	Pin				654-MS3116F14-19S	MS3116F14-19S	Socket			
26	16-26	#20	7.5A	654-MS3112E16-26S	MS3112E16-26S	Socket				654-MS3116F16-26P	MS3116F16-26P	Pin			
26	16-26	#20	7.5A	654-MS3112E16-26P	MS3112E16-26P	Pin				654-MS3116F16-26S	MS3116F16-26S	Socket			
32	18-32	#20	7.5A	654-MS3112E18-32S	MS3112E18-32S	Socket				654-MS3116F18-32P	MS3116F18-32P	Pin			
32	18-32	#20	7.5A	654-MS3112E18-32P	MS3112E18-32P	Pin				654-MS3116F18-32S	MS3116F18-32S	Socket			
41	20-41	#20	7.5A	654-MS3112E20-41S	MS3112E20-41S	Socket				654-MS3116F20-41P	MS3116F20-41P	Pin			
41	20-41	#20	7.5A	654-MS3112E20-41P	MS3112E20-41P	Pin				654-MS3116F20-41S	MS3116F20-41S	Socket			
55	22-55	#16	13.0A	654-MS3112E22-55S	MS3112E22-55S	Socket				654-MS3116F22-55P	MS3116F22-55P	Pin			
55	22-55	#16	13.0A	654-MS3112E22-55P	MS3112E22-55P	Pin				654-MS3116F22-55S	MS3116F22-55S	Socket			
61	24-61	#20	7.5A	654-MS3112E24-61S	MS3112E24-61S	Socket				654-MS3116F24-61P	MS3116F24-61P	Pin			
61	24-61	#20	7.5A	654-MS3112E24-61P	MS3112E24-61P	Pin				654-MS3116F24-61S	MS3116F24-61S	Socket			