

MOLEX Cable Assemblies

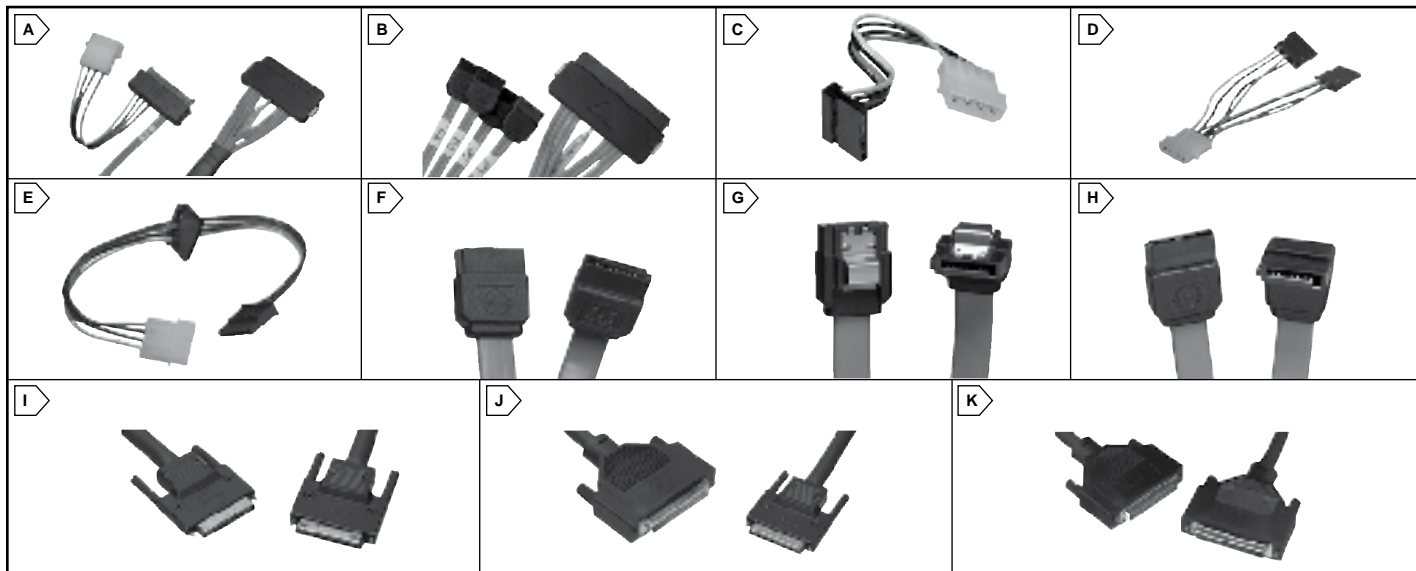

MOLEX SERIAL ATTACHED SCSI (SAS) CABLE ASSEMBLIES

Molex SAS cable assemblies support the next generation of storage devices for enterprise storage markets offering increased scalability and flexibility at high-speed data rates. SAS delivers speeds ranging from 1.5 Gbps to 6.0 Gbps. This allows OEMs and integrators to provide systems with the interconnect granularity and bandwidth that eliminates the need to invest in new connectors for generations to come. Also, users do not have to test and qualify two different families of connectors because the mating interface is the same for both internal and external applications, saving additional costs.

Applications:

- HBAs (Host Bus Adapters)
- Servers
- Storage racks
- Switches / routers
- RAID's (Redundant Array of Independent Disks)
- JBOD's (Just a Bunch of Disks)



RoHS Compliant

For quantities of 10 and up, call for quote.

MOUSER STOCK NO.	Molex Part No.	Fig.	Description	Length (Feet)	Price Each	
					1	5
538-68810-0020	68810-0020	A	SAS 4i to 4(1x) SAS HDD Internal Controller-Based Fanout Cable Assembly	3.3		
538-68810-0002	68810-0002	B	SAS 4i to 4(1x) SATA-Style Internal Backplane-Based Fanout Cable Assembly w/o SB (Target)	3.3		

MOLEX SERIAL ATA CABLE ASSEMBLIES

Serial ATA cable assemblies offer high-quality data transfer at high speeds. Molex leads the connector industry with the largest growing family of Serial ATA interconnect solutions that support this platform, including latching versions. Serial ATA is compliant with SATA-I/O specification for speeds up to 3.0 Gbps.

Applications:

- | | | | |
|--|--|---|--|
| <p>Desktop Computing:</p> <ul style="list-style-type: none"> • Hard Disk Drive • Motherboard • Power Supply • Adapters • Controller Boards • Data Protection • Workstation | <p>Emerging Trends:</p> <ul style="list-style-type: none"> • Set-Top Box • Digital Audio • Automotive - Navigation • Brown Goods • Optical Drives • HDTV Home Theatre • Games - 3d Video | <p>Enterprise Computing:</p> <ul style="list-style-type: none"> • Mid Range Servers • Network Storage • RAID Storage • Backplane • Internet Service | <p>Mobile Computing:</p> <ul style="list-style-type: none"> • Notebook PC • Sub-Notebook PC • Media PC • Multimedia Peripherals |
|--|--|---|--|



RoHS Compliant

For quantities of 25 and up, call for quote.

MOUSER STOCK NO.	Molex Part No.	Fig.	Description	Length	Price Each		
					1	5	10
538-68809-0012	68809-0012	C	SATA IDT Power Cable 6in (Au Flash)	6 inches			
538-68809-0001	68809-0001	C	SATA Power Cable 15 Pin Power (F) to 4 Pin (M)	6 inches			
538-68809-0002	68809-0002	C	SATA Power Cable 15 Pin Power (F) to 4 Pin (M)	8 inches			
538-68809-0003	68809-0003	D	SATA Dual Power Cable 2 x 15 Pin (F) to 4 Pin (M)	1.0 foot			
538-68809-0004	68809-0004	E	SATA Power Cable 15 Pin Power (F) to 15 Pin Power (F) + 4 Pin (M) 6in	6 inches			
538-68809-0005	68809-0005	F	SATA Signal Cable 7 pin Straight to Straight	1.6 feet			
538-68809-0006	68809-0006	F	SATA Signal Cable 7 pin Straight to Straight	3.3 feet			
538-68809-0010	68809-0010	G	SATA Signal Cable 7 pin Straight to R/A w/latch	3.3 feet			
538-68809-0013	68809-0013	H	SATA Signal Cable 7 pin Straight to R/A	1.6 feet			
538-68809-0014	68809-0014	H	SATA Signal Cable 7 pin Straight to R/A	3.3 feet			

MOLEX SCSI AND VHDCI CABLE ASSEMBLIES

Molex's offering of SCSI (Small Computer Systems Interface) provides a wide range of cable assemblies featuring SCSI-3 connectors for data-transfer applications. The 68 circuit cables are designed for attaching disk drives and other devices internally or externally, supporting the interconnect needs that comply with SCSI-3 U320 specifications. Molex's Ultra+ VHDCI (Very High Density Cable Interconnect) system is a leader among the next generation of high-density I/O interconnects. These 68 circuit cables are designed for high performance memory transfer applications supporting the latest SCSI style interfaces. They offer increased density compared to existing SCSI connector styles. They are also suited for other high density I/O needs.

Applications:

- Mainframes
- File servers
- Workstations
- RAID (Redundant Arrays of Inexpensive Disks)
- Tape and Disk Drives
- Applications requiring hi-speed memory transfers



RoHS Compliant

For quantities of 10 and up, call for quote.

MOUSER STOCK NO.	Molex Part No.	Fig.	Description	Length (Feet)	Price Each	
					1	5
538-79918-0080	79918-0080	I	External VHDCI-VHDCI Cable Assembly	6.6		
538-79562-0004	79562-0004	J	External VHDCI-SCSI3 Cable Assembly	3.3		
538-79562-0005	79562-0005	J	External VHDCI-SCSI3 Cable Assembly	6.6		
538-79562-0006	79562-0006	J	External VHDCI-SCSI3 Cable Assembly	10		
538-79562-0009	79562-0009	K	External SCSI3-SCSI3 Cable Assembly	6.6		
538-79562-0011	79562-0011	K	External SCSI3-SCSI3 Cable Assembly	16.4		