

PANASONIC Fixed Inductors



This product is RoHS compliant.

HIGH POWER

ELJ-PB Series 1812 Case Size

Applications:

- AV equipment, Wireless communication equipment and various types of general electronic equipment

Features:

- Low DCR and large current capability, suitable for power circuitry
- Wire wound, resin molded chip inductor. (PC, PA, PB types)
- Capable of being Re-flow or flow soldered
- Wide line-up from 1005 to 4532 case sizes • Good for mounting

Specifications:

- Operating Temperature : -20 to +85 °C



Recommended land patterns in mm (not to scale)

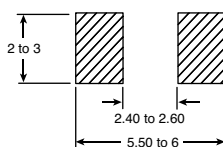

DIMENSIONS: mm (not to scale)

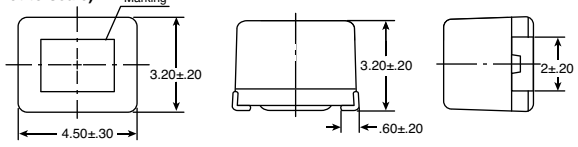

For quantities greater than listed, call for quote.

MOUSER STOCK NO.	Panasonic Part No.	Inductance			Q		SRF (MHz min)	DCR (Ω)	Irms (mA)	Price Each			
		Value (μH)	Tol.	Test Freq. (MHz)	Min.	Test Freq. (MHz)				1	50	100	500
667-ELJ-PB100KF	ELJ-PB100KF	10	±10%	2.52	10	2.52	19	0.65	360				
667-ELJ-PB120KF	ELJ-PB120KF	12	±10%	2.52	10	2.52	17	0.7	340				
667-ELJ-PB150KF	ELJ-PB150KF	15	±10%	2.52	10	2.52	15	0.8	320				
667-ELJ-PB180KF	ELJ-PB180KF	18	±10%	2.52	10	2.52	14	0.9	310				
667-ELJ-PB220KF	ELJ-PB220KF	22	±10%	2.52	10	2.52	13	1	300				
667-ELJ-PB270KF	ELJ-PB270KF	27	±10%	2.52	10	2.52	11	1.2	270				
667-ELJ-PB330KF	ELJ-PB330KF	33	±10%	2.52	10	2.52	10	1.4	250				
667-ELJ-PB390KF	ELJ-PB390KF	39	±10%	2.52	10	2.52	9.5	1.6	230				
667-ELJ-PB470KF	ELJ-PB470KF	47	±10%	2.52	10	2.52	8.5	1.9	210				
667-ELJ-PB560KF	ELJ-PB560KF	56	±10%	2.52	10	2.52	8	2.2	190				
667-ELJ-PB680KF	ELJ-PB680KF	68	±10%	2.52	10	2.52	7	2.6	170				
667-ELJ-PB820KF	ELJ-PB820KF	82	±10%	2.52	10	2.52	6.5	3.5	160				
667-ELJ-PB101KF	ELJ-PB101KF	100	±10%	0.796	20	0.796	6	4	150				
667-ELJ-PB121KF	ELJ-PB121KF	120	±10%	0.796	20	0.796	5.5	4.5	130				
667-ELJ-PB151KF	ELJ-PB151KF	150	±10%	0.796	20	0.796	5	6.5	120				
667-ELJ-PB181KF	ELJ-PB181KF	180	±10%	0.796	20	0.796	4.5	7.5	110				
667-ELJ-PB221KF	ELJ-PB221KF	220	±10%	0.796	20	0.796	0	0	0				

GENERAL USE

ELJ-FC Series 1008 Case Size

Applications:

- AV equipment, Wireless communication equipment and various types of general electronic equipment

Features:

- General use wire wound, resin molded chip inductor
- Capable of being Re-flow or flow soldered
- Wide line-up from 2520 to 4532 case sizes
- Good for mounting

Specifications:

- Operating Temperature : -20 to +85 °C



Recommended land patterns in mm (not to scale)

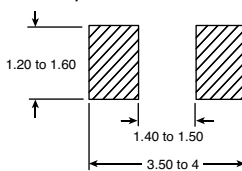

DIMENSIONS: mm (not to scale)

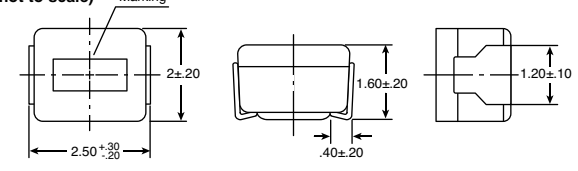

For quantities greater than listed, call for quote.

MOUSER STOCK NO.	Panasonic Part No.	Inductance			Q		SRF (MHz min)	DCR (Ω)	Irms (mA)	Price Each			
		Value (μH)	Tol.	Test Freq. (MHz)	Min.	Test Freq. (MHz)				1	50	100	500
667-ELJ-FC1R0JF	ELJ-FC1R0JF	1.0	±5%	7.96	25	7.96	115	0.65	195				
667-ELJ-FC1R2JF	ELJ-FC1R2JF	1.2	±5%	7.96	25	7.96	100	0.75	180				
667-ELJ-FC1R5JF	ELJ-FC1R5JF	1.5	±5%	7.96	25	7.96	90	0.85	170				
667-ELJ-FC1R8JF	ELJ-FC1R8JF	1.8	±5%	7.96	25	7.96	85	0.95	160				
667-ELJ-FC2R2JF	ELJ-FC2R2JF	2.2	±5%	7.96	25	7.96	80	1.05	155				
667-ELJ-FC2R7JF	ELJ-FC2R7JF	2.7	±5%	7.96	25	7.96	75	1.2	145				
667-ELJ-FC3R3JF	ELJ-FC3R3JF	3.3	±5%	7.96	25	7.96	65	1.3	135				
667-ELJ-FC3R9JF	ELJ-FC3R9JF	3.9	±5%	7.96	25	7.96	60	1.4	130				
667-ELJ-FC4R7JF	ELJ-FC4R7JF	4.7	±5%	7.96	25	7.96	55	1.55	125				
667-ELJ-FC5R6JF	ELJ-FC5R6JF	5.6	±5%	7.96	25	7.96	50	1.75	120				
667-ELJ-FC6R8JF	ELJ-FC6R8JF	6.8	±5%	7.96	25	7.96	45	1.95	115				
667-ELJ-FC8R2JF	ELJ-FC8R2JF	8.2	±5%	7.96	25	7.96	40	2.2	105				
667-ELJ-FC100JF	ELJ-FC100JF	10	±5%	2.52	25	2.52	32	3.7	80				
667-ELJ-FC120JF	ELJ-FC120JF	12	±5%	2.52	25	2.52	30	4.1	75				
667-ELJ-FC150JF	ELJ-FC150JF	15	±5%	2.52	25	2.52	28	5	70				
667-ELJ-FC180JF	ELJ-FC180JF	18	±5%	2.52	25	2.52	25	5.4	65				
667-ELJ-FC220JF	ELJ-FC220JF	22	±5%	2.52	25	2.52	22	6	60				
667-ELJ-FC270JF	ELJ-FC270JF	27	±5%	2.52	20	2.52	21	6.3	115				
667-ELJ-FC330JF	ELJ-FC330JF	33	±5%	2.52	20	2.52	20	7.1	110				
667-ELJ-FC390JF	ELJ-FC390JF	39	±5%	2.52	20	2.52	18	9.5	90				
667-ELJ-FC470JF	ELJ-FC470JF	47	±5%	2.52	20	2.52	17	11	80				
667-ELJ-FC560JF	ELJ-FC560JF	56	±5%	2.52	20	2.52	16	12.1	75				
667-ELJ-FC680JF	ELJ-FC680JF	68	±5%	2.52	20	2.52	15	16.6	70				
667-ELJ-FC820JF	ELJ-FC820JF	82	±5%	2.52	20	2.52	13	19	65				
667-ELJ-FC101JF	ELJ-FC101JF	100	±5%	0.796	15	0.796	12	21	60				
667-ELJ-FRCR22KF	ELJ-FRCR22KF	0.22	±10%	25.2	25	25.2	230	0.7	190				
667-ELJ-FRCR27KF	ELJ-FRCR27KF	0.27	±10%	25.2	25	25.2	210	0.75	180				
667-ELJ-FRCR39KF	ELJ-FRCR39KF	0.39	±10%	25.2	25	25.2	175	0.95	160				
667-ELJ-FRCR47KF	ELJ-FRCR47KF	0.47	±10%	25.2	25	25.2	160	1	155				
667-ELJ-FRCR68KF	ELJ-FRCR68KF	0.68	±10%	25.2	25	25.2	135	1.25	140				
667-ELJ-FRCR82KF	ELJ-FRCR82KF	0.82	±10%	25.2	25	25.2	125	1.4	130				
667-ELJ-FC1R0KF	ELJ-FC1R0KF	1.0	±10%	7.96	25	7.96	115	0.65	195				
667-ELJ-FC1R2KF	ELJ-FC1R2KF	1.2	±10%	7.96	25	7.96	100	0.75	180				
667-ELJ-FC1R5KF	ELJ-FC1R5KF	1.5	±10%	7.96	25	7.96	90	0.85	170				
667-ELJ-FC1R8KF	ELJ-FC1R8KF	1.8	±10%	7.96	25	7.96	85	0.95	160				
667-ELJ-FC2R2KF	ELJ-FC2R2KF	2.2	±10%	7.96	25	7.96	80	1.05	155				
667-ELJ-FC2R7KF	ELJ-FC2R7KF	2.7	±10%	7.96	25	7.96	75	1.2	145				
667-ELJ-FC3R3KF	ELJ-FC3R3KF	3.3	±10%	7.96	25	7.96	65	1.3	135				
667-ELJ-FC3R9KF	ELJ-FC3R9KF	3.9	±10%	7.96	25	7.96	60	1.4	130				
667-ELJ-FC4R7KF	ELJ-FC4R7KF	4.7	±10%	7.96	25	7.96	55	1.55	125				
667-ELJ-FC5R6KF	ELJ-FC5R6KF	5.6	±10%	7.96	25	7.96	50	1.75	120				
667-ELJ-FC6R8KF	ELJ-FC6R8KF	6.8	±10%	7.96	25	7.96	45	1.95	115				
667-ELJ-FC8R2KF	ELJ-FC8R2KF	8.2	±10%	7.96	25	7.96	40	2.2	105				
667-ELJ-FC100KF	ELJ-FC100KF	10	±10%	2.52	25	2.52	32	3.7	80				
667-ELJ-FC120KF	ELJ-FC120KF	12	±10%	2.52	25	2.52	30	4.1	75				
667-ELJ-FC150KF	ELJ-FC150KF	15	±10%	2.52	25	2.52	28	5	70				
667-ELJ-FC180KF	ELJ-FC180KF	18	±10%	2.52	25	2.52	25	5.4	65				
667-ELJ-FC220KF	ELJ-FC220KF	22	±10%	2.52	25	2.52	22	6	60				
667-ELJ-FC101KF	ELJ-FC101KF	100	±10%	0.796	15	0.796	12	21	60				
667-ELJ-FRCR22MF	ELJ-FRCR22MF	0.22	±20%	25.2	25	25.2	230	0.7	190				
667-ELJ-FRCR27MF	ELJ-FRCR27MF	0.27	±20%	25.2	25	25.2	210	0.75	180				
667-ELJ-FRCR33MF	ELJ-FRCR33MF	0.33	±20%	25.2	25	25.2	190	0.85	170				